

## 8" (Ø 272 mm) Technical Information

### Tank Unit (Adapter) and Hose Unit (Coupler)



Material	Maximum Working Pressure	Test Pressure	Minimum Burst Pressure
Aluminium	10 bar / 145 psi	15 bar / 218 psi	50 bar / 726 psi
Stainless Steel	16 bar / 232 psi	24 bar / 348 psi	80 bar / 1160 psi

### Connections

8" flanged inlet (or NPT thread)

### Applications

Recommended for marine bunkering, ship to shore transfer, ship to ship transfer and ship to rig transfer or on any application where spillage needs to be minimized.

### Media

**Petroleum products:** gasoline, diesel, oil etc.

**Chemical products:** ethylene oxide, propylene oxide, acrylonitrile, butadiene, ammonia, vinyl chloride, toluene, xylene, sulphuric acid, phenol etc.

**Dry powder**

### Material of Body

Aluminium, brass/gunmetal, stainless steel, Hastelloy and PEEK. Other materials on request.

### Seals

Standard seals FPM (Viton®), EPDM, FFKM (Chemraz®, Kalrez®), NBR. Other on request.

### High Flow Rates / Low Pressure Drop

Allows maximum product transfer with minimal losses

### Recommended Maximum Flow Rates

7500 litres/minute (fuel)

### Selectivity

**- avoid mixing products**

To avoid product contamination caused by connecting a hose unit to the wrong tank unit, selective versions of the hose and tank units are available.

Each unit has a number of selective positions, designated by a coded part number according to the coupling size – specify when placing order. See page 32 ff.

### Interchangeability

Compatible with couplings of other manufacturers.

### Hose Unit with Integrated Swivel

All hose units are supplied with an integrated swivel.

## 8" (Ø 272 mm) Tank Unit (Adapter) – Flanged Inlet

Flange <sup>1)</sup>	Body Material <sup>2)</sup>	Seal <sup>3)</sup>	Weight ≈		Mann Tek Code No.	
		O-Ring	kg	lbs		
DN 200 PN 10 Type A	AI	Standard: <b>FPM/FKM</b> (Viton®)			<b>T8102A1101</b>	
DN 200 PN 16 Type A					<b>T8103A1101</b>	
8" ASA 150					<b>T8105A1101</b>	
DN 200 PN 10 Type B	SS				<b>T8102A4401</b>	
DN 200 PN 16 Type B			Other on request.			<b>T8103A4401</b>
8" ASA 150				39,0	86.0	<b>T8105A4401</b>

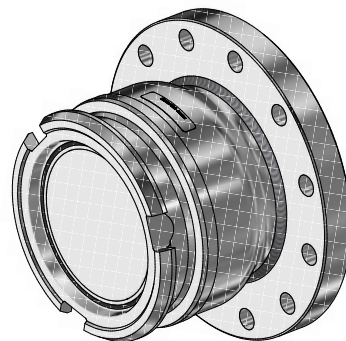

\*) alternatively also available with NPT female inlet

## 8" (Ø 272 mm) Coupler – Flanged Inlet

Flange <sup>1)</sup>	Body Material <sup>2)</sup>	Seal <sup>3)</sup>	Weight ≈		Mann Tek Code No.
		O-Ring	kg	lbs	
DN 200 PN 10 Type A	AI	Standard: <b>FPM/FKM</b> (Viton®)			<b>S8102A1101</b>
DN 200 PN 16 Type A					<b>S8103A1101</b>
8" ASA 150			93,0	205.0	<b>S8105A1101</b>
DN 200 PN 10 Type B	SS				<b>S8102A4401</b>
DN 200 PN 16 Type B					<b>S8103A4401</b>
8" ASA 150			93,0	205.0	<b>S8105A4401</b>

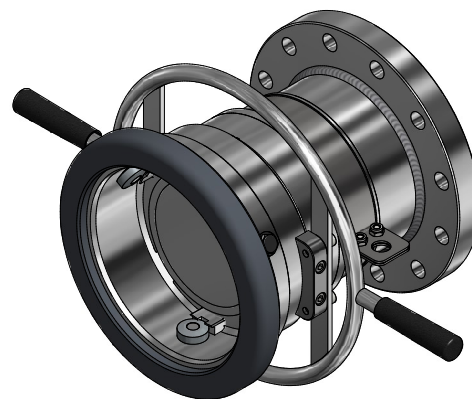

\*) alternatively also available with NPT female inlet

<sup>1)</sup> PN 10/16/25/40 = EN 1092 (types see page 44), ASA = ANSI B16.5 (150 psi)

<sup>2)</sup> Material: AI = Aluminium, SS = Stainless Steel

<sup>3)</sup> Standard seal FPM/FKM. Alternative materials, e.g. EPDM, Chemraz®, Kalrez®, NBR or HNBR on request

Viton® is a registered trademark of DuPont, DuPont Elastomers.